

Trapezoidal Screw Threads-One End Double Stepped-Right-hand Thread
30度梯形螺桿-單邊台階型-右螺牙

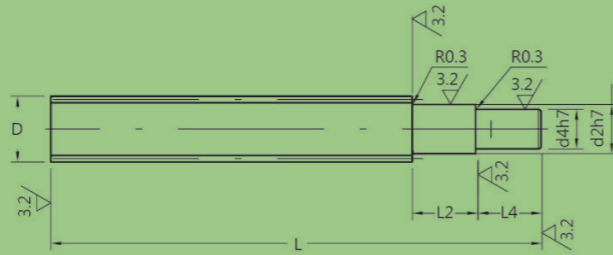

HW-TSP007



Type 項次	Material 材質	Surface Treatment 表面處理	Delivery 交貨日
HW-TSP007-A	S45C 中碳鋼	-	10 Working Days
HW-TSP007-B		Blackening 染黑	10 個工作日

Type	D	L (u:1mm)	L2/L4 (u:1mm)	d2	d4 (u:1mm)	Pitch
HW-TSP007-A HW-TSP007-B	10	80~1000	2≤L4≤d2 or d4x7 2≤L2≤d2x7 ※ When d2,d4≤9 L2≤d2x5 L4≤d4x5	6/7	d2/2≤d4≤d2-2	2
	12	80~1000		6/7/8/9		2
	14	80~1000		8/9/10		3
	16	100~1200		9/10/12		3
	18	150~1200		9/10/12		4
	20	150~1200		10/12/14/15		4
	22	150~1200		10/12/14/15		5
	25	150~1200		12/14/15/16/17		5
	28	150~1200		14/15/16/17/20		5
	32	200~1200		14/15/16/17/20/25		6
36	200~1200	17/20/25	6			
40	200~1200	20/25/30	6			
50	200~1200	25/30/35/40	8			

Order Ex. 訂購範例

HW-TSP007-D-L-d2-L2-d4-L4

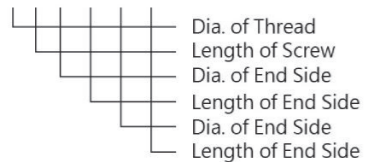

螺紋尺寸
螺桿長度
軸端尺寸
軸端長度
軸端尺寸
軸端長度

Trapezoidal Screw Threads-One End Double Stepped-Right-hand Thread
30度梯形螺桿-單邊台階型-右螺牙

Alterations 追加加工名稱	Description 加工說明	Order Ex. 訂購範例																																																												
A	Flat Machining 平面追加加工。	HW-TSP007-10-80-6-10-4-10-Ad2-3(L5)-5(L6)-1(L7) Flat Machining at the d2 Side. 在d2端進行平面追加加工。																																																												
B	Retaining Ring Groove 扣環溝槽追加加工。 <table border="1"> <tr><th>d4</th><th>e</th><th>m</th><th>n</th></tr> <tr><td>7</td><td>4</td><td>+0.075</td><td>0.7</td></tr> <tr><td>8</td><td>5</td><td>0</td><td>0.9</td></tr> <tr><td>9</td><td>6</td><td>0</td><td>0.9</td></tr> <tr><td>10</td><td>9.6</td><td>0</td><td>-0.09</td></tr> <tr><td>12</td><td>11.5</td><td>0</td><td>-0.09</td></tr> <tr><td>14</td><td>13.4</td><td>0</td><td>-0.11</td></tr> <tr><td>15</td><td>14.3</td><td>0</td><td>-0.11</td></tr> <tr><td>16</td><td>15.2</td><td>0</td><td>-0.11</td></tr> <tr><td>17</td><td>16.2</td><td>0</td><td>-0.11</td></tr> <tr><td>20</td><td>19</td><td>0</td><td>-0.11</td></tr> <tr><td>25</td><td>23.9</td><td>0</td><td>-0.21</td></tr> <tr><td>30</td><td>28.6</td><td>0</td><td>-0.21</td></tr> <tr><td>35</td><td>33</td><td>0</td><td>-0.25</td></tr> <tr><td>40</td><td>38</td><td>0</td><td>-0.25</td></tr> </table>	d4	e	m	n	7	4	+0.075	0.7	8	5	0	0.9	9	6	0	0.9	10	9.6	0	-0.09	12	11.5	0	-0.09	14	13.4	0	-0.11	15	14.3	0	-0.11	16	15.2	0	-0.11	17	16.2	0	-0.11	20	19	0	-0.11	25	23.9	0	-0.21	30	28.6	0	-0.21	35	33	0	-0.25	40	38	0	-0.25	HW-TSP007-10-80-6-10-4-10-Bd4-6(L8) Retaining Ring Groove at the d4 Side. 在d4端進行扣環溝槽追加加工。
d4	e	m	n																																																											
7	4	+0.075	0.7																																																											
8	5	0	0.9																																																											
9	6	0	0.9																																																											
10	9.6	0	-0.09																																																											
12	11.5	0	-0.09																																																											
14	13.4	0	-0.11																																																											
15	14.3	0	-0.11																																																											
16	15.2	0	-0.11																																																											
17	16.2	0	-0.11																																																											
20	19	0	-0.11																																																											
25	23.9	0	-0.21																																																											
30	28.6	0	-0.21																																																											
35	33	0	-0.25																																																											
40	38	0	-0.25																																																											
C	Wrench Flats 二面寬度追加加工。	HW-TSP007-10-80-6-10-4-10-Cd4-3(L5)-5(L6)-5(L7) Wrench Flats at the d4 Side. 在d4端進行二面寬度追加加工。																																																												
E	Coarse Tapping 攻牙孔追加加工。 <table border="1"> <tr><th>d4</th><th>M</th></tr> <tr><td>5/6</td><td>3</td></tr> <tr><td>7/8</td><td>3/4</td></tr> <tr><td>9/10</td><td>3/4/5</td></tr> <tr><td>11/12</td><td>3/4/5/6</td></tr> <tr><td>13-15</td><td>3/4/5/6/8</td></tr> <tr><td>16-24</td><td>3/4/5/6/8/10</td></tr> <tr><td>25-30</td><td>3/4/5/6/8/10/12/16</td></tr> <tr><td>31-39</td><td>3/4/5/6/8/10/12/16/20</td></tr> <tr><td>40/50</td><td>3/4/5/6/8/10/12/16/20/24/30</td></tr> </table>	d4	M	5/6	3	7/8	3/4	9/10	3/4/5	11/12	3/4/5/6	13-15	3/4/5/6/8	16-24	3/4/5/6/8/10	25-30	3/4/5/6/8/10/12/16	31-39	3/4/5/6/8/10/12/16/20	40/50	3/4/5/6/8/10/12/16/20/24/30	HW-TSP007-10-80-6-10-4-10-Ed4-M3 Coarse Tapping at the d4 Side. 在d4端進行攻牙孔追加加工。																																								
d4	M																																																													
5/6	3																																																													
7/8	3/4																																																													
9/10	3/4/5																																																													
11/12	3/4/5/6																																																													
13-15	3/4/5/6/8																																																													
16-24	3/4/5/6/8/10																																																													
25-30	3/4/5/6/8/10/12/16																																																													
31-39	3/4/5/6/8/10/12/16/20																																																													
40/50	3/4/5/6/8/10/12/16/20/24/30																																																													
F	Square Chamfering 四角面追加加工。 <table border="1"> <tr><th>d2</th><th>L6</th></tr> <tr><td>6-10</td><td>5-8</td></tr> <tr><td>11-14</td><td>8-10</td></tr> <tr><td>15-19</td><td>10-14</td></tr> <tr><td>20-25</td><td>14-20</td></tr> <tr><td>26-30</td><td>19-24</td></tr> <tr><td>31-35</td><td>22-28</td></tr> <tr><td>36-40</td><td>26-30</td></tr> </table>	d2	L6	6-10	5-8	11-14	8-10	15-19	10-14	20-25	14-20	26-30	19-24	31-35	22-28	36-40	26-30	HW-TSP007-10-80-6-10-4-10-Fd2-5(L5)-5(L6) Square Chamfering at the d2 Side. 在d2端進行四角面追加加工。																																												
d2	L6																																																													
6-10	5-8																																																													
11-14	8-10																																																													
15-19	10-14																																																													
20-25	14-20																																																													
26-30	19-24																																																													
31-35	22-28																																																													
36-40	26-30																																																													
G	Threaded 外螺牙追加加工。 <table border="1"> <tr><th>d2</th><th>MxPitch</th><th>d2</th><th>MxPitch</th></tr> <tr><td>6</td><td>M6x0.75</td><td>17</td><td>M17x1.0</td></tr> <tr><td>8</td><td>M8x1.0</td><td>20</td><td>M20x1.0</td></tr> <tr><td>10</td><td>M10x1.0</td><td>25</td><td>M25x1.5</td></tr> <tr><td>12</td><td>M12x1.0</td><td>30</td><td>M30x1.5</td></tr> <tr><td>14</td><td>M14x1.0</td><td>35</td><td>M35x1.5</td></tr> <tr><td>15</td><td>M15x1.0</td><td>40</td><td>M40x1.5</td></tr> </table>	d2	MxPitch	d2	MxPitch	6	M6x0.75	17	M17x1.0	8	M8x1.0	20	M20x1.0	10	M10x1.0	25	M25x1.5	12	M12x1.0	30	M30x1.5	14	M14x1.0	35	M35x1.5	15	M15x1.0	40	M40x1.5	HW-TSP007-10-80-6-10-4-10-Gd2-5(L5) Threaded at the d2 Side. 在d2端進行外螺牙追加加工。																																
d2	MxPitch	d2	MxPitch																																																											
6	M6x0.75	17	M17x1.0																																																											
8	M8x1.0	20	M20x1.0																																																											
10	M10x1.0	25	M25x1.5																																																											
12	M12x1.0	30	M30x1.5																																																											
14	M14x1.0	35	M35x1.5																																																											
15	M15x1.0	40	M40x1.5																																																											
H	Keyway 鍵槽追加加工。 <table border="1"> <tr><th>d2</th><th colspan="4">keyway size 輪槽的尺寸</th></tr> <tr><td>6/7</td><td>b1</td><td>TOL</td><td>t1</td><td>TOL</td></tr> <tr><td>8-10</td><td>2</td><td>-0.004</td><td>1.2</td><td></td></tr> <tr><td></td><td>3</td><td>-0.029</td><td>1.8</td><td></td></tr> <tr><td>12</td><td>4</td><td>0</td><td>2.5</td><td>+0.1</td></tr> <tr><td>14-17</td><td>5</td><td>-0.030</td><td>3.0</td><td>0</td></tr> <tr><td>20</td><td>6</td><td>0</td><td>3.5</td><td></td></tr> <tr><td>25/30</td><td>8</td><td>0</td><td>4.0</td><td></td></tr> <tr><td>35</td><td>10</td><td>-0.036</td><td>5.0</td><td>+0.2</td></tr> <tr><td>40</td><td>12</td><td>0</td><td>5.0</td><td>0</td></tr> <tr><td></td><td></td><td>-0.043</td><td></td><td></td></tr> </table>	d2	keyway size 輪槽的尺寸				6/7	b1	TOL	t1	TOL	8-10	2	-0.004	1.2			3	-0.029	1.8		12	4	0	2.5	+0.1	14-17	5	-0.030	3.0	0	20	6	0	3.5		25/30	8	0	4.0		35	10	-0.036	5.0	+0.2	40	12	0	5.0	0			-0.043			HW-TSP007-10-80-6-10-4-10-Hd2-5(L5)-3(L6) Keyway at the d2 Side. 在d2端進行鍵槽追加加工。					
d2	keyway size 輪槽的尺寸																																																													
6/7	b1	TOL	t1	TOL																																																										
8-10	2	-0.004	1.2																																																											
	3	-0.029	1.8																																																											
12	4	0	2.5	+0.1																																																										
14-17	5	-0.030	3.0	0																																																										
20	6	0	3.5																																																											
25/30	8	0	4.0																																																											
35	10	-0.036	5.0	+0.2																																																										
40	12	0	5.0	0																																																										
		-0.043																																																												