

HTP028

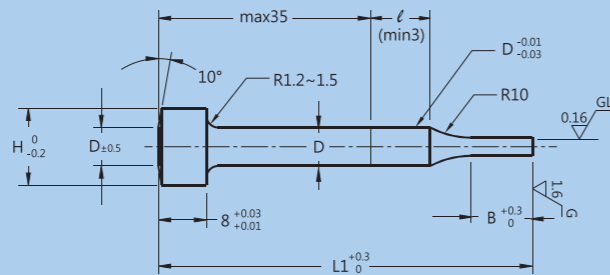

Type 品名	Material 材質	Hardness 硬度	Surface Treatment 表面處理	Delivery 交貨日
HTP028-A	SKH51	61~64HRC	Lapping Type 拋光加工	8 Working Days 8 個工作日
HTP028-B	Powdered Highspeed Steel 粉末高速鋼	64~67HRC		

D Tolerance 柄部直徑公差	
a	m5
b	+0.005 0

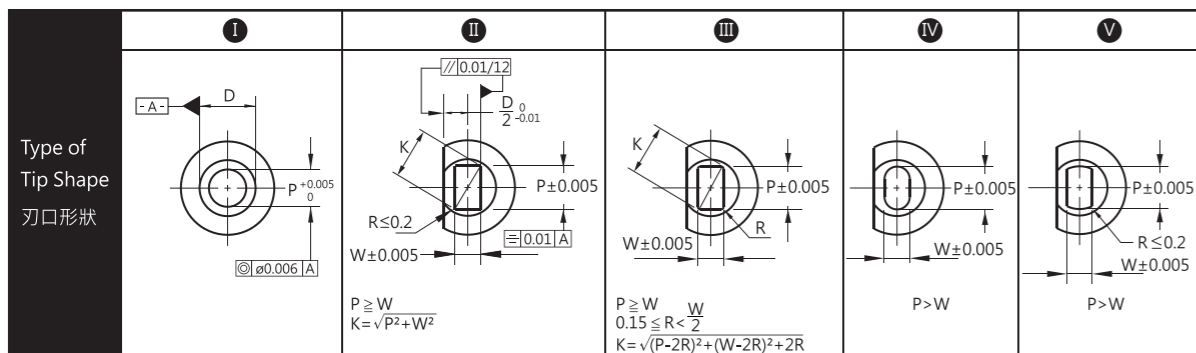

Type 品名	Tip Length 刃口長度	D	L1 (u: 10mm)	I (u:0.001mm) min. P max.	II/III/IV/V (u:0.001mm) P·Kmax.	II/III/IV/V (u:0.001mm) P·Wmin.	III (u:0.01mm) R	B	H
HTP028-A HTP028-B	S	5	50~80	2.000~4.990	4.970	1.200	0.15 ≤ R < W/2	8	10
		6	50~80	2.000~5.990	5.970	1.500		8	11
		8	(50)~100	3.000~7.990	7.970	2.000		13	13
		10	(50)~100	3.000~9.990	9.970	2.500		13	15
		13	(50)~100	6.000~12.990	12.970	3.000		13	18
		16	(50)~100	10.000~15.990	15.970	4.000		19	21
		20	(50)~100	13.000~19.990	19.970	5.000		19	25
	25	(50)~100	18.000~24.990	24.970	6.000	19		30	
	L	5	60~80	2.000~4.990	4.970	1.200		13	10
		6	60~80	2.000~5.990	5.970	1.500		13	11
		8	60~100	3.000~7.990	7.970	2.000		19	13
		10	60~100	3.000~9.990	9.970	2.500		19	15
		13	60~100	6.000~12.990	12.970	3.000		19	18
		16	70~100	10.000~15.990	15.970	4.000		25	21
20		70~100	13.000~19.990	19.970	5.000	25	25		
25	70~100	18.000~24.990	24.970	6.000	25	30			

* L1 (50)→B=8 If full length is (50), tip length is 8mm in all cases.
全長為(50)時·刃口長度一律為8mm

* I : P>D-0.03→ℓ=0
If P>D-0.03 for a round punch, D^{-0.01/-0.03} (press-in lead) is not included.
圓沖頭P>D-0.03時·不附D^{-0.01/-0.03} (導入部)

* II/III/IV/V : P·K>D-0.05→ℓ=0
If P·K>D-0.05 for a shaped punch, D^{-0.01/-0.03} (press-in lead) is not included.
變形沖頭P·K>D-0.05時·不附D^{-0.01/-0.03} (導入部)

Order Ex. 訂購範例

HTP028-□-5-L1-P-W-□-□-□

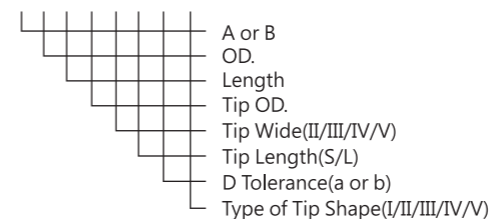

沖頭材質
外徑
長度
前端外徑
前端寬度(II/III/IV/V)
刃口長度(S/L)
柄部直徑公差(a or b)
刃口形狀(I/II/III/IV/V)

Alterations	追加加工名稱	Description	加工說明	Alterations	追加加工名稱	Description	加工說明
Alterations to Tip	PC WC	Tip dimension change 變更刃口尺寸 *請參考表14	Full length change 變更全長 *請參考表4	Alterations to Full Length	LC	Full length change 變更全長 *請參考表4	
	BC	Tip length change 變更刃口長度 *請參考表8			LKC LKZ	Full length tolerance change 變更全長公差	
Alterations to Head	PRC	Rounding of tip side edge 刃口側端面R加工	Addition key flats 止迴加工	Alterations to Head to Shank	KC WKC KFC NKC	Addition key flats 止迴加工	
	PCC	Chamfering to tip side edge 刃口側端面C倒角加工			SKC	Single key flat on shank 柄部平面加工(1面)	
*追加加工詳細說明請參考產品概要-追加加工說明				Alterations to Shank	NDC	No press-in lead 無導入部	